

KEY PLAN
(PREVIOUS PROPOSAL)
AS PER COMPOSITE PLAN
SECTOR B4, PKT-3

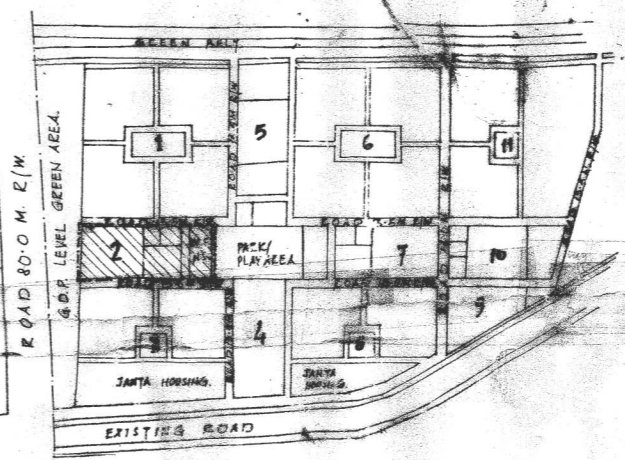

KEY PLAN
(REVISED PROPOSAL)
SECTOR B-4, PKT-2

TOTAL AREA OF SCHEME
231.71 X 92.70 M = 21,479.52 SQM (INCLUDING FACILITY & C.S.F. PLOT.)

LAND USE	AREA
• AREA UNDER PLOTS	= 18,524.51 SQM (86%)
• FACILITIES (P.S., PUMP HOUSE, E.S.S., MILK BOOTH, BANGALU)	= 4,410.85 SQM (20%)
• C.S.C.	= 1087.02 SQM (5%)
• PARK	= 1169.48 SQM (5.4%)
• ROADS & PATH	= 4228.66 SQM (19.6%)

DETAIL OF PLOTS

SL. NO.	SIZE OF PLOT (M X M)	NO. OF PLOTS
1 TO 4	13.20 M X 25.00 M	4
5 TO 10	15.00 M X 25.00 M	6
11 TO 14	13.20 M X 25.00 M	4
15 TO 23	9.90 M X 21.00 M	9
24 TO 33	9.90 M X 21.00 M	10
34 TO 42	10.00 M X 10.75 M	9

TOTAL PLOTS 42

NOTES

1. ALL CORNER PLOTS (RESIDENTIAL) WILL HAVE A CHAMFER OF 1M X 1M AT THE CORNER.
2. LAY OUT PLAN HAS BEEN APPROVED BY BY COMM. PLG ON 9.4.2002 AT PAGE NO. 32/N IN FILE NO. 15 (145) 2002-NP
3. THE DEMARCATION OF PLOTS AS WELL AS SERVICES (WATER SUPPLY, SEWER LINES AND S.W. DRAINS) HAS BEEN LAID DOWN AT SITE AS INFORMED BY EXECUTIVE ENGINEER, NO-12/DDA VIDE LETTER NO. F3(72)03/NO-12/DDA/1246, DATED: 14/12/04. AT PAGE NO. 96 IN FILE NO. F 15 (145) 2002-NP.

MIG INCREMENTAL FLATS

DDA FLATS

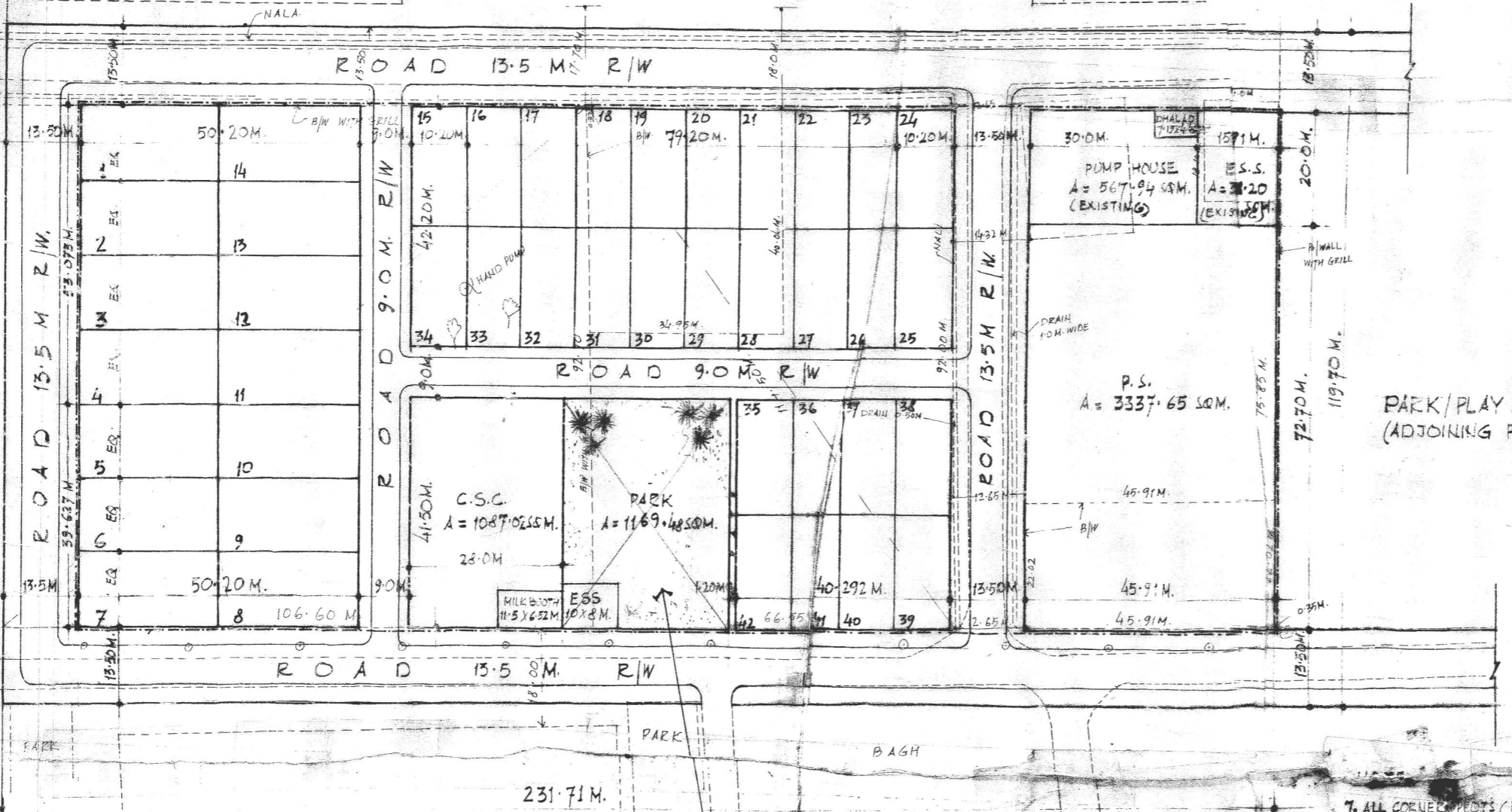

FLATS
MIG. INCREMENTAL

E.S.S. & PARK MODIFIED BY 249th
SCREENING COMMITTEE MEETING
HELD ON 4-07-2006 IN THE FILE NO. F 15 (145) 2002 NP
(FOR DETAILS REFER DRG. NO- 450)

7. ALL CORNER PLOTS (RESIDENTIAL) WILL HAVE A CHAMFER OF 1M X 1M AT THE CORNER.
8. LAY OUT PLAN HAS BEEN APPROVED BY BY COMM. PLG ON 9.4.2002 AT PAGE NO. 32/N IN FILE NO. 15 (145) 2002-NP
9. THE DEMARCATION OF PLOTS AS WELL AS SERVICES (WATER SUPPLY, SEWER LINES AND S.W. DRAINS) HAS BEEN LAID DOWN AT SITE AS INFORMED BY EXECUTIVE ENGINEER, NO-12/DDA VIDE LETTER NO. F3(72)03/NO-12/DDA/1246, DATED: 14/12/04. AT PAGE NO. 96 IN FILE NO. F 15 (145) 2002-NP.